

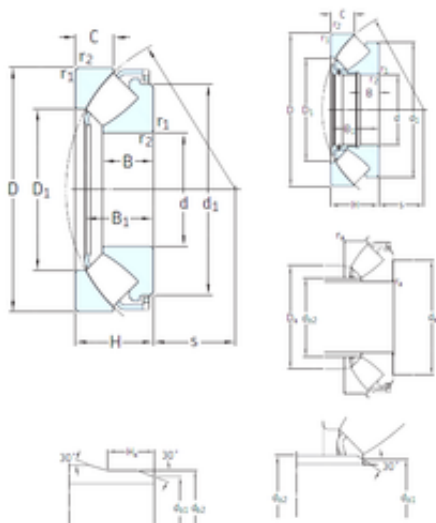

BEARING DRIVESHAFT ANDERSON, INC.



750 mm x 1000 mm x 93 mm SKF 292/750EM
Thrust roller bearings

Bearing No. 292/750EM

Size	750x1000x74 mm
Bore Diameter	750 mm
Outer Diameter	1000 mm
Width	74 mm
d	750 mm
D	1000 mm
C	74 mm
H	150 mm
d1	950 mm
r1 min.	6 mm
r2 min.	6 mm
s	409 mm
B	93 mm
B1	144 mm
D1	858 mm
da min.	880 mm
Da max.	925 mm
ra max.	5 mm
Weight	325 Kg
Basic dynamic load rating (C)	6100 kN
Basic static load rating (C0)	31000 kN
Fatigue load limit (Pu)	2320
Reference speed	340 r/min
Limiting speed	560 r/min

292/750EM Bearing 2D drawings and 3D CAD models