

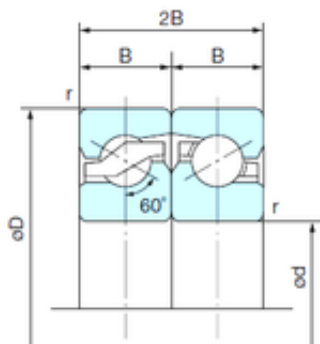

BEARING DRIVESHAFT ANDERSON, INC.

17 mm x 47 mm x 15 mm NACHI 17TAB04DF Thrust ball bearings



Bearing No. 17TAB04DF

17TAB04DF Bearing 2D drawings and 3D CAD models

Size	17x47x15 mm
Bore Diameter	17 mm
Outer Diameter	47 mm
Width	15 mm
d	17 mm
D	47 mm
B	15 mm
C	15 mm
Angle (°)	60 °
r min.	1 mm
r1 min.	0.6 mm
2B	30 mm
Weight	0.13 Kg
Basic dynamic load rating (C)	25,9 kN
Basic static load rating (C0)	32 kN
Bore Type	Cylindrical Bore
Enclosure	Open
Configuration	Double Row
Bore Size	17 mm
Outside Diameter	47 mm
Width	15 mm
Fillet Radius/Chamfer	1 mm
r1	0.6 mm
Dynamic Load Rating	25,900 N
Static Load Rating	32,000 N



BEARING DRIVESHAFT ANDERSON, INC.

Limiting Speed - Grease	6,300 rpm
Limiting Speed - Oil	8,000 rpm
Starting Torque - Grease Lubrication	15 N · cm
da1 (min)	33.7 mm
da2 (min)	26.8 mm
Da1 (max)	33.5 mm
Da2 (max)	41 mm