

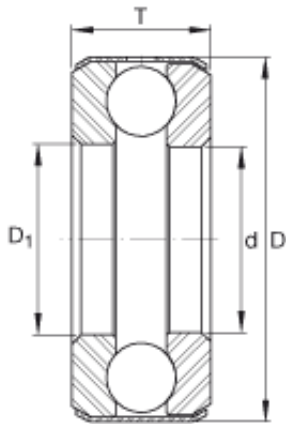

BEARING DRIVESHAFT ANDERSON, INC.



INA D3 Thrust ball bearings

Bearing No. D3

Size	15.875x34.138x14.3 mm
Bore Diameter	15,875 mm
Outer Diameter	34,138 mm
Width	14,3 mm
d	5/8 inch
d	15,875 mm
D	1,344 inch
D	34,138 mm
T	0,563 inch
T	14,3 mm
D ₁	0,656 inch
m	0,14 lbs / Weight
m	63 g / Weight
C _a	4100 lbf / Dynamic load rating (axial)
C _a	18200 N / Dynamic load rating (axial)
C _{0a}	6700 lbf / Static load rating (axial)
C _{0a}	29800 N / Static load rating (axial)
Category	Thrust Ball Bearing
Inventory	7.0
Manufacturer Name	SCHAEFFLER GROUP
Minimum Buy Quantity	N/A
Weight / Kilogram	0
EAN	4012802146844

D3 Bearing 2D drawings and 3D CAD models



BEARING DRIVESHAFT ANDERSON, INC.

Product Group	B04270
Rolling Element	Ball Bearing
Thrust Bearing	Yes
Single or Double Direction	Single Direction
Banded	Yes
Cage Material	Steel
Precision Class	ABEC 1 ISO P0
Component Description	Roller Assembly Plus Raceways
Other Features	Single Row
Long Description	5/8" Bore 1; 21/32" Bore 2; 1-11/32" Outside Diameter; 9/16" Height; Ball Bearing; Single Direction; Banded; Steel Cage; ABEC 1 ISO P0 Precision
Inch - Metric	Inch
Category	Thrust Ball Bearings
UNSPSC	31171552
Harmonized Tariff Code	8482.10.50.08
Noun	Bearing
Keyword String	Ball Thrust
Manufacturer URL	http://www.ina.com
Weight / LBS	0.138
Outside Diameter	1.344 Inch 34.138 Millimeter
Height	0.563 Inch 14.3 Millimeter
Bore 2	0.656 Inch 16.662 Millimeter
Overall Height with Aligning Washer	0 Inch 0 Millimeter
Bore 1	0.625 Inch 15.875 Millimeter