

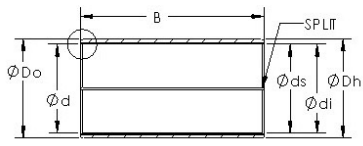

BEARING DRIVESHAFT ANDERSON, INC.



AST AST850SM 7050 Plain bearings

Bearing No. AST850SM 7050

| | |
|--|--------------------------------|
| Bore Diameter | 70 mm |
| Outer Diameter | 75 mm |
| Bearing Type | metal with bronze and graphite |
| Shaft Dia., Nominal (d) | 70.0000 |
| Shaft Size (ds) - 70 +0 / -0.046 | 70 +0 / 0.046 |
| Housing Bore Dia. (Dh) - 75 +0.030 / -0 | 75 +0.030 / 0 |
| Bearing Outside Diameter, Nominal(Do) | 75.000 |
| Bearing Bore after Mounting (di) | 70 +0.230 / +0.080 |
| Average Clearance (Cd) | 0.1550 |
| Wall Thickness (S3) | 2.430 |
| Bearing Length, Nominal (B) | 50.000 |
| Bearing Length Tolerance (B tol.) - +0 / -0.40 | +0 / 0.40 |
| OD Chamfer Length (Co) | 1.800 |
| ID Chamfer Angle (B deg.) | 45 |
| ID Chamfer Length (Ci) | 0.600 |

AST850SM 7050 Bearing 2D drawings and 3D CAD models