

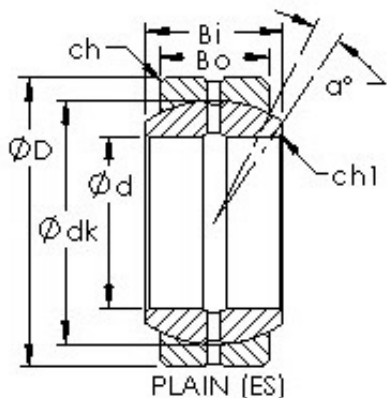

BEARING DRIVESHAFT ANDERSON, INC.



AST GE40ES Plain bearings

Bearing No. GE40ES

Bore Diameter	40 mm
Outer Diameter	62 mm
Bearing Type	plain
Bore Dia (d)	40.0000
Outer Dia (D)	62.0000
Outer Width (Bo)	22.0000
Inner Width (Bi)	28.0000
Dynamic Load Rating (Cr)	99,000
Static Load Rating (Cor)	495,000
Max. shaft corner radius, or 45 deg. chamfer (ch1)	0.600
Max. housing corner radius, or 45 deg. chamfer (ch)	1.000
Spherical Diameter (dk or Dk)	53.000
Mis-alignment Angle (a deg.)	7
Weight (g)	318.00
Material	52100 Chrome steel, or equivalent

GE40ES Bearing 2D drawings and 3D CAD models