

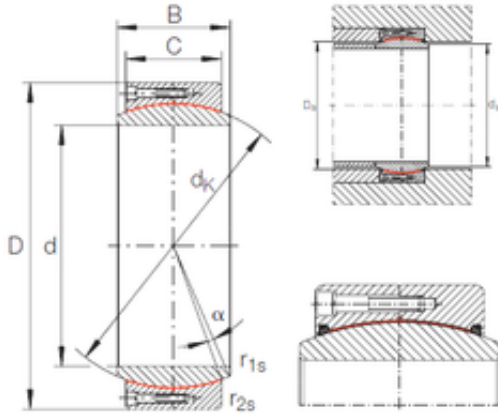

BEARING DRIVESHAFT ANDERSON, INC.

480 mm x 650 mm x 230 mm INA GE 480 DW
Plain bearings



Bearing No. GE 480 DW

Size	480x650x230 mm
Bore Diameter	480 mm
Outer Diameter	650 mm
Width	230 mm
d	480 mm
D	650 mm
B	230 mm
C	195 mm
dk	565 mm
r1 min.	2 mm
r2 min.	5 mm
da max	516 mm
Da min	536 mm
Angle	3,8 °
Weight	234 Kg
Basic dynamic load rating (C)	33,05 kN

GE 480 DW Bearing 2D drawings and 3D CAD models