

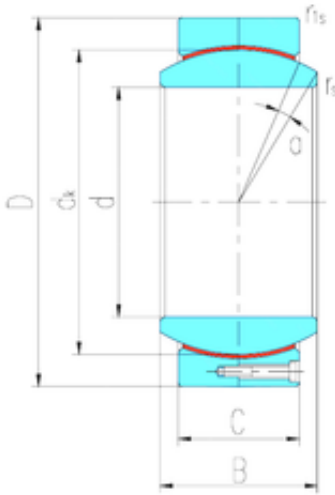

BEARING DRIVESHAFT ANDERSON, INC.



560 mm x 750 mm x 258 mm LS GEC560HT
Plain bearings

Bearing No. GEC560HT

Size	560x750x258 mm
Bore Diameter	560 mm
Outer Diameter	750 mm
Width	258 mm
d	560 mm
D	750 mm
B	258 mm
C	215 mm
dk	655 mm
r min.	2 mm
r1 min.	5 mm
Angle	4 °
Weight	345 Kg
Basic dynamic load rating (C)	25340 kN

GEC560HT Bearing 2D drawings and 3D CAD models