

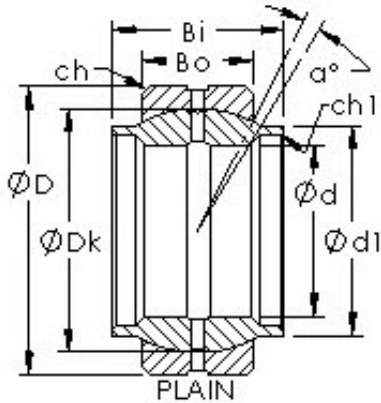

BEARING DRIVESHAFT ANDERSON, INC.



AST GEWZ82ES Plain bearings

Bearing No. GEWZ82ES

Bore Diameter	82,55 mm
Outer Diameter	130,175 mm
Bearing Type	plain
Bore Dia (d)	3.2500
Outer Dia (D)	5.1250
Outer Width (Bo)	2.4370
Inner Width (Bi)	4.8750
Dynamic Load Rating (Cr)	131,505
Static Load Rating (Cor)	395,639
Max. shaft corner radius, or 45 deg. chamfer (ch1)	0.040
Max. housing corner radius, or 45 deg. chamfer (ch)	0.040
Spherical Diameter (dk or Dk)	4.685
Mis-alignment Angle (a deg.)	5
Extended Inner OD (d1)	3.985
Weight (g)	4,690.00
Material	52100 chrome steel, or equivalent

GEWZ82ES Bearing 2D drawings and 3D CAD models