

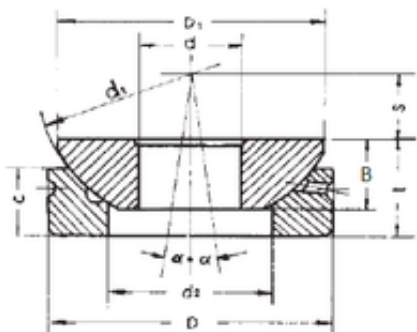

BEARING DRIVESHAFT ANDERSON, INC.

120 mm x 230 mm x 53,5 mm FBJ GX120S Plain bearings



Bearing No. GX120S

Size	120x230x64 mm
Bore Diameter	120 mm
Outer Diameter	230 mm
Width	64 mm
d	120 mm
D	230 mm
T	64 mm
B	53,5 mm
C	50 mm
d1	250 mm
d2	145 mm
D1	220 mm
S	52,5 mm
Angle	6 °
Weight	13,97 Kg
Basic dynamic load rating (C)	1250 kN

GX120S Bearing 2D drawings and 3D CAD models