

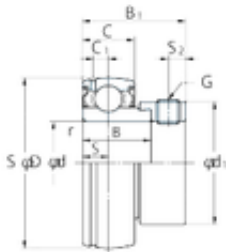

BEARING DRIVESHAFT ANDERSON, INC.

36,5125 mm x 80 mm x 30,2 mm KOYO
SA208-25F Deep groove ball bearings



Bearing No. SA208-25F

Size	36.5125x80x30.2 mm
Bore Diameter	36,5125 mm
Outer Diameter	80 mm
Width	30,2 mm
d	36,5125 mm
D	80 mm
B	30,2 mm
B1	43,7 mm
C	22 mm
d1	60,3 mm
r min.	1,1 mm
C	6,4 mm
S	11 mm
S2	6,8 mm
Thread (G) - 5/16-24UNF	5/1624UNF
Weight	0,75 Kg
Basic dynamic load rating (C)	29,1 kN
Basic static load rating (C0)	17,8 kN

SA208-25F Bearing 2D drawings and 3D CAD models