

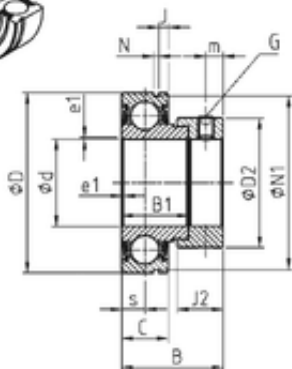

BEARING DRIVESHAFT ANDERSON, INC.



34,925 mm x 72 mm x 38,9 mm SNR
CES207-22 Deep groove ball bearings

Bearing No. CES207-22

| | |
|-------------------------------|-------------------|
| Size | 34.925x72x38.9 mm |
| Bore Diameter | 34,925 mm |
| Outer Diameter | 72 mm |
| Width | 38,9 mm |
| d | 34,925 mm |
| D | 72 mm |
| B | 38,9 mm |
| B1 | 25,4 mm |
| C | 17 mm |
| e | 1,5 mm |
| a | 3,96875 mm |
| m | 6,5 mm |
| s | 8,5 mm |
| D2 | 55,6 mm |
| J | 3,18 mm |
| N | 1,9 mm |
| N1 | 68,81 mm |
| Thread (G) - 5/16-24UNF | 5/1624UNF |
| J2 | 17,5 mm |
| Weight | 0,51 Kg |
| Basic dynamic load rating (C) | 25,7 kN |
| b | 1.9 mm |
| B2 | 17.5 mm |
| d1 | 55.6 mm |
| G | 5/16-24UNF |

CES207-22 Bearing 2D drawings and 3D CAD models



BEARING DRIVESHAFT ANDERSON, INC.

| | |
|---|---------|
| r | 1.5 |
| S | 8.5 mm |
| SW | 3.97 mm |
| C0 | 15.2 kN |
| T min. | -20 ° C |
| T max. | 100 ° C |
| Recommended tightening torque for set screw | 8 Nm |