

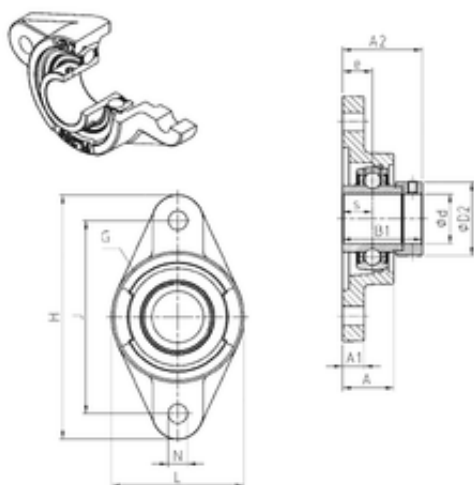

BEARING DRIVESHAFT ANDERSON, INC.



SNR EXFL307 Bearing units

Bearing No. EXFL307

Bore Diameter	35 mm
d	35 mm
e	20 mm
s	18,3 mm
A	36 mm
A1	16 mm
B1	51,6 mm
D2	55 mm
H	185 mm
J	141 mm
L	100 mm
N	23 mm
Thread (G)	M6x1
A2	53,3 mm
Weight	1,8 Kg
Basic dynamic load rating (C)	33,5 kN

EXFL307 Bearing 2D drawings and 3D CAD models